

## Active Extrusion Components

### Programmable CNC Die

To change the section of the extruded part In real-time or between parts

### Quad-Barrel Extrusion Drive

Applies variable pressure to each quadrant of the die to change direction of extruded part

### Dynamic Material Mixer

Dynamically controls hardener to material ratio

# Programmable Extrusion Die

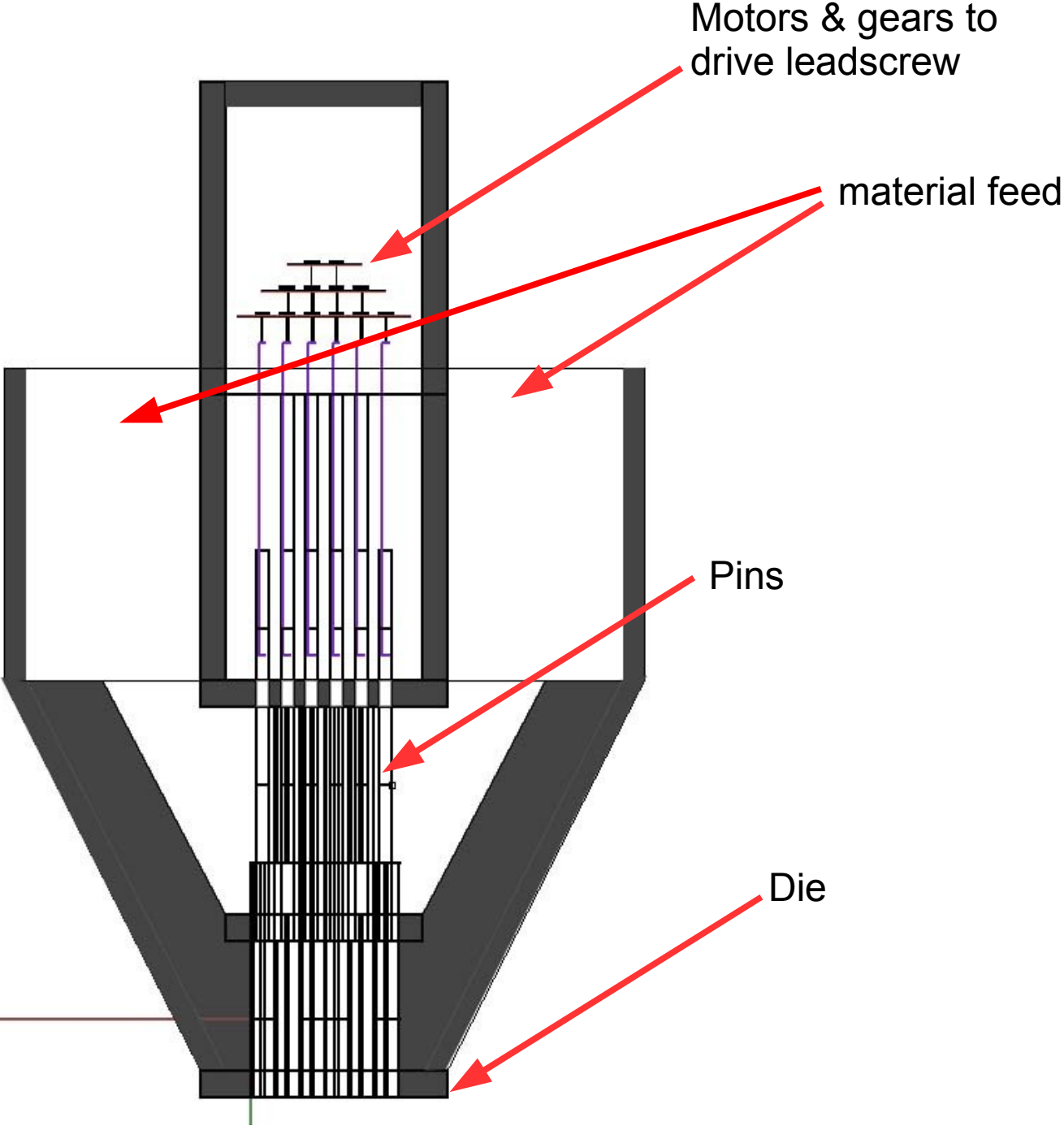

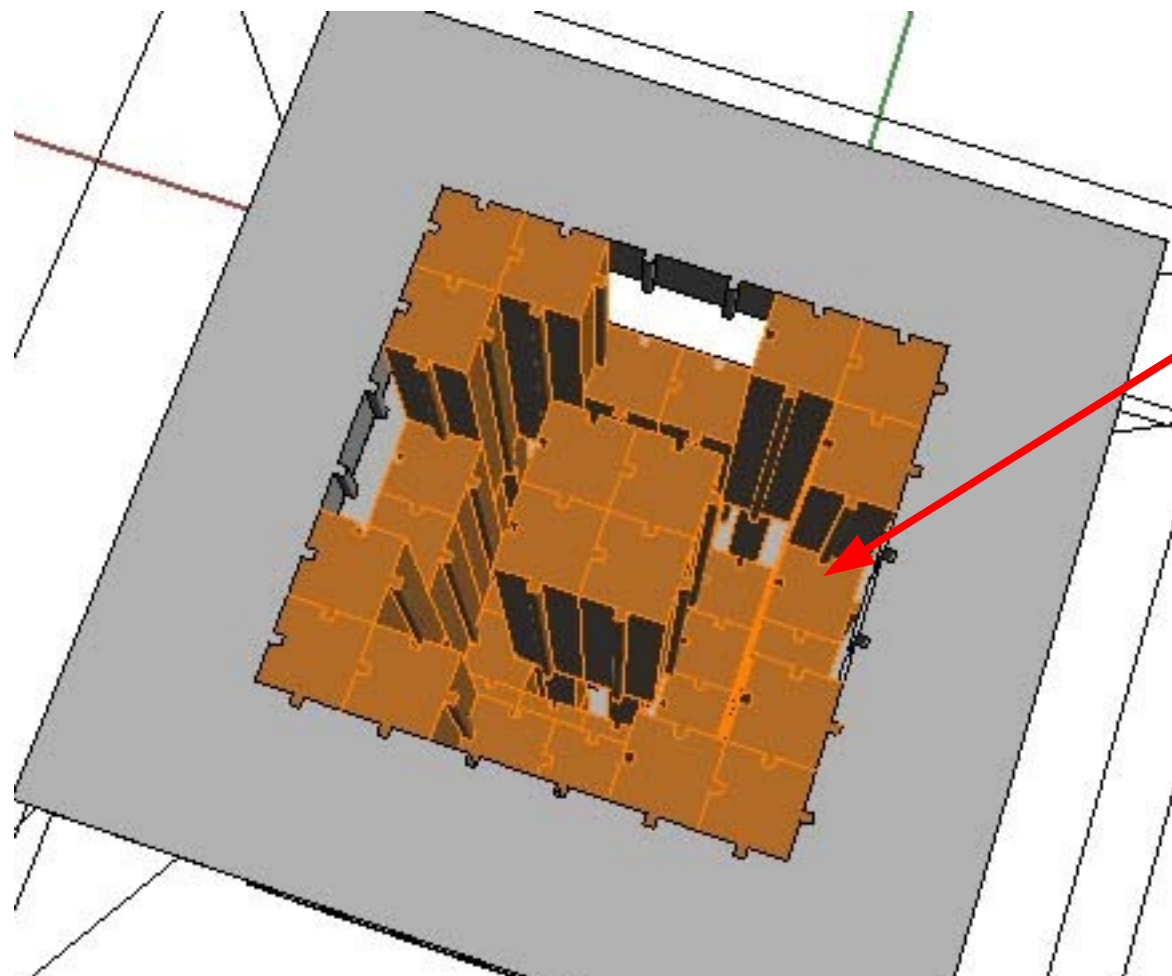

Retracted pins

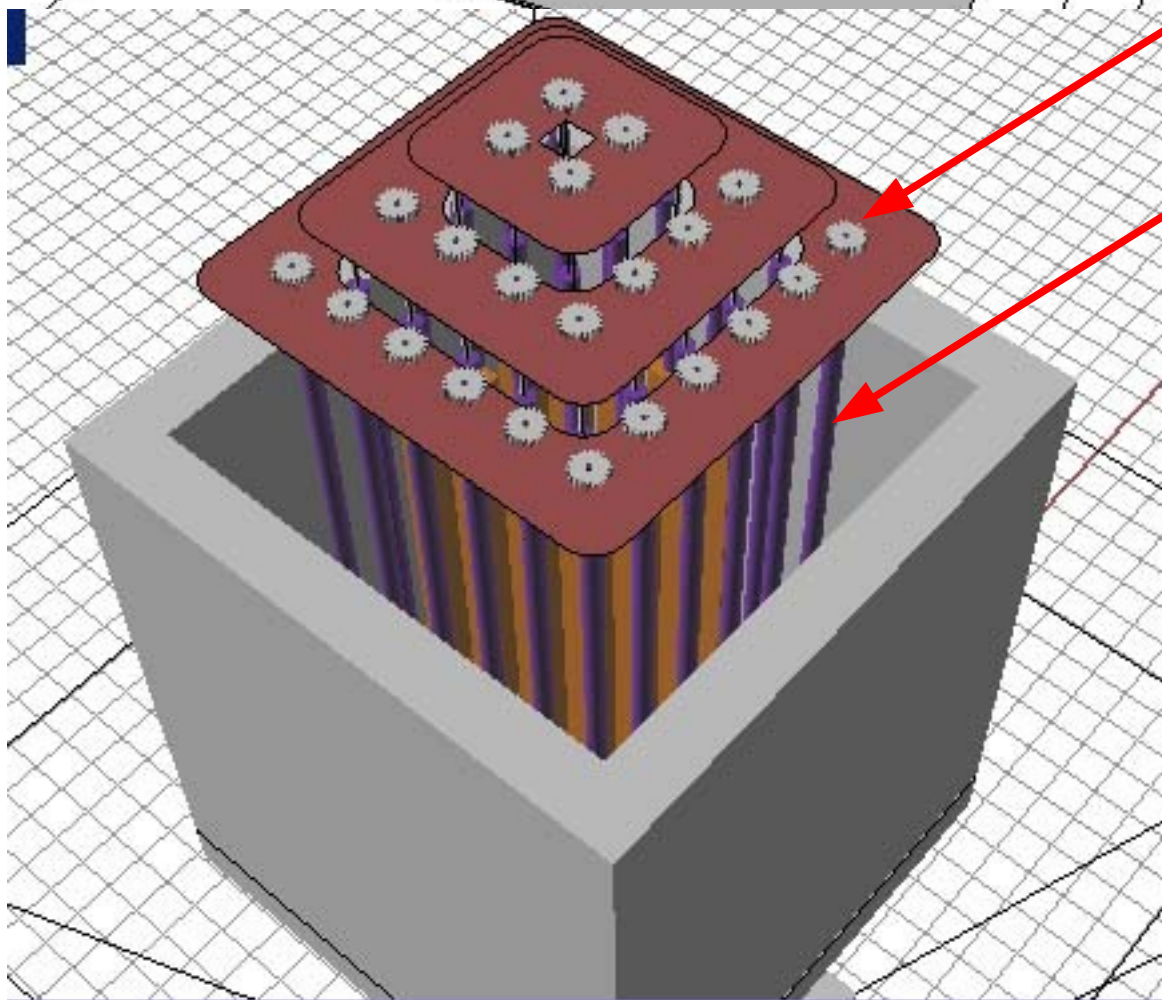

Gear and motor mount

Leadscrew connected to die pin

---

Detail of Pin

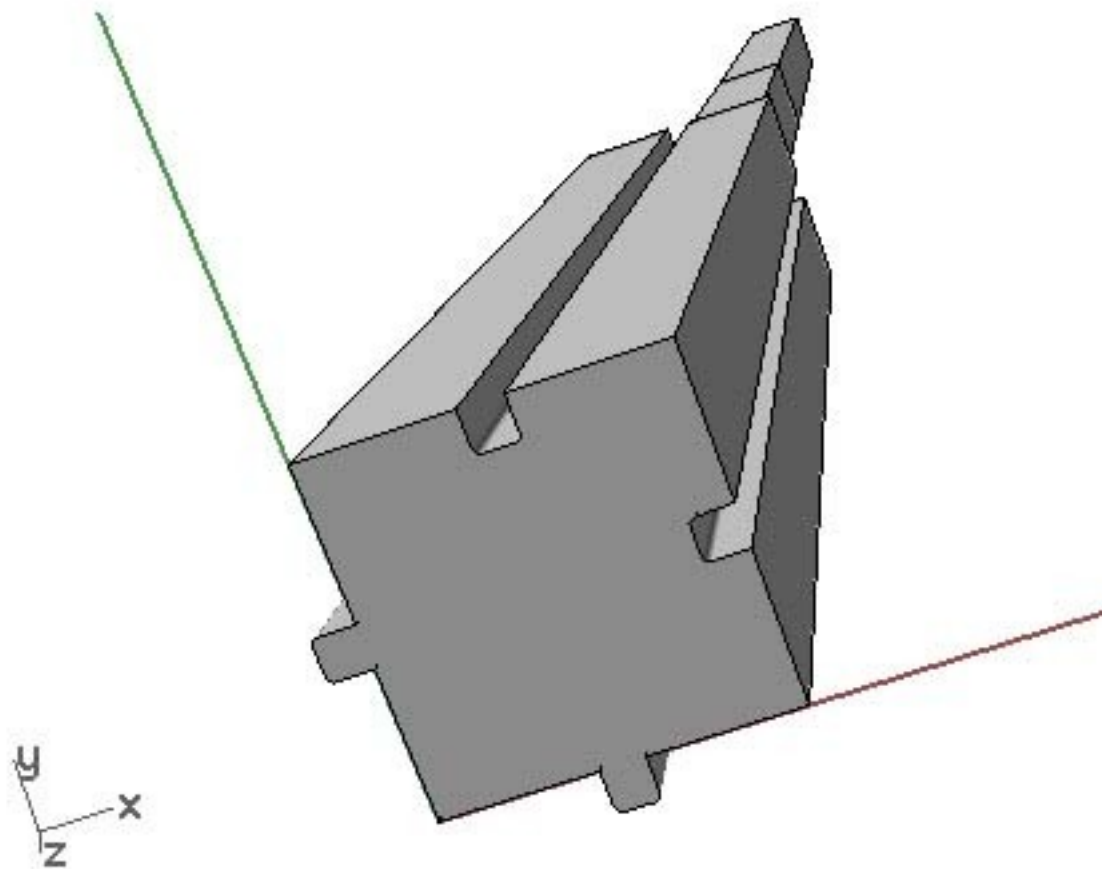
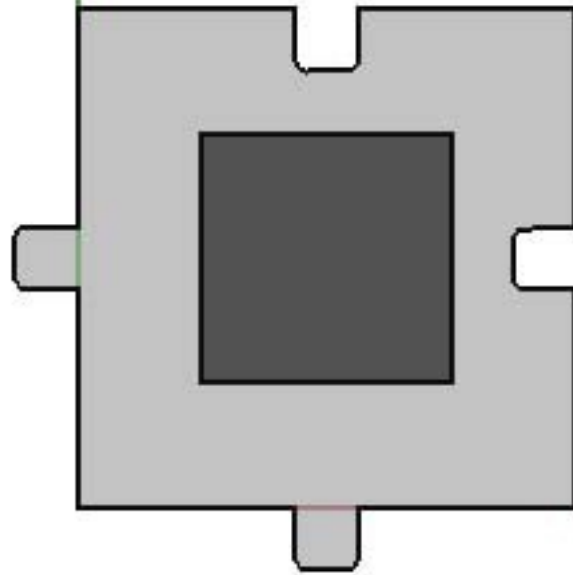

A 6x6 array of pins

36 stepper motors to retract pins to the open position by turning a gear that will be attached to a leadscrew

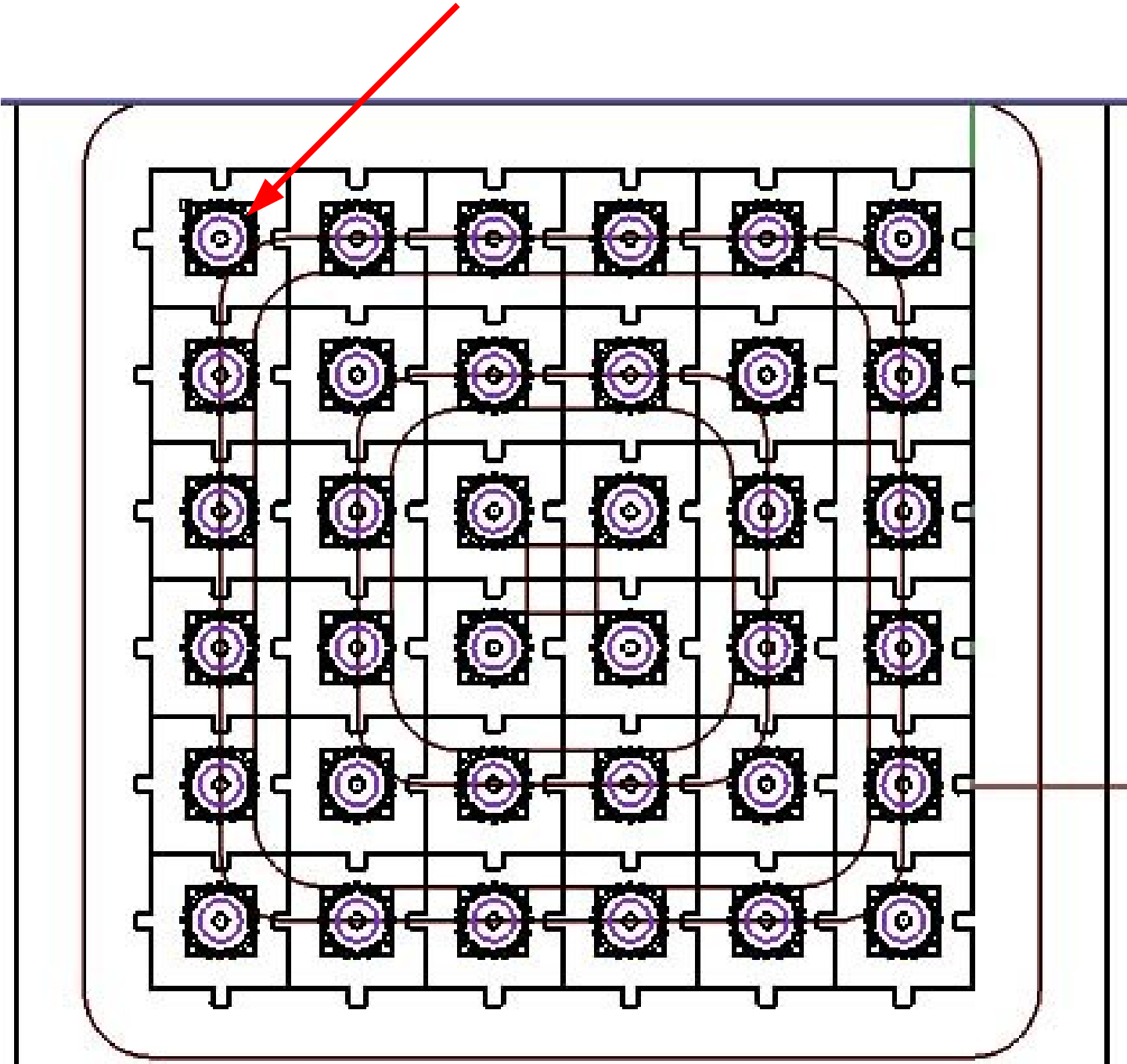



## Quad Barrel Extrusion Drive

to control pressure on four sides which will change direction of extruded part

Each four barrels will have a motor to control the material feed rate, which will control pressure on each quadrant of the die to change shape and direction of the extruded part

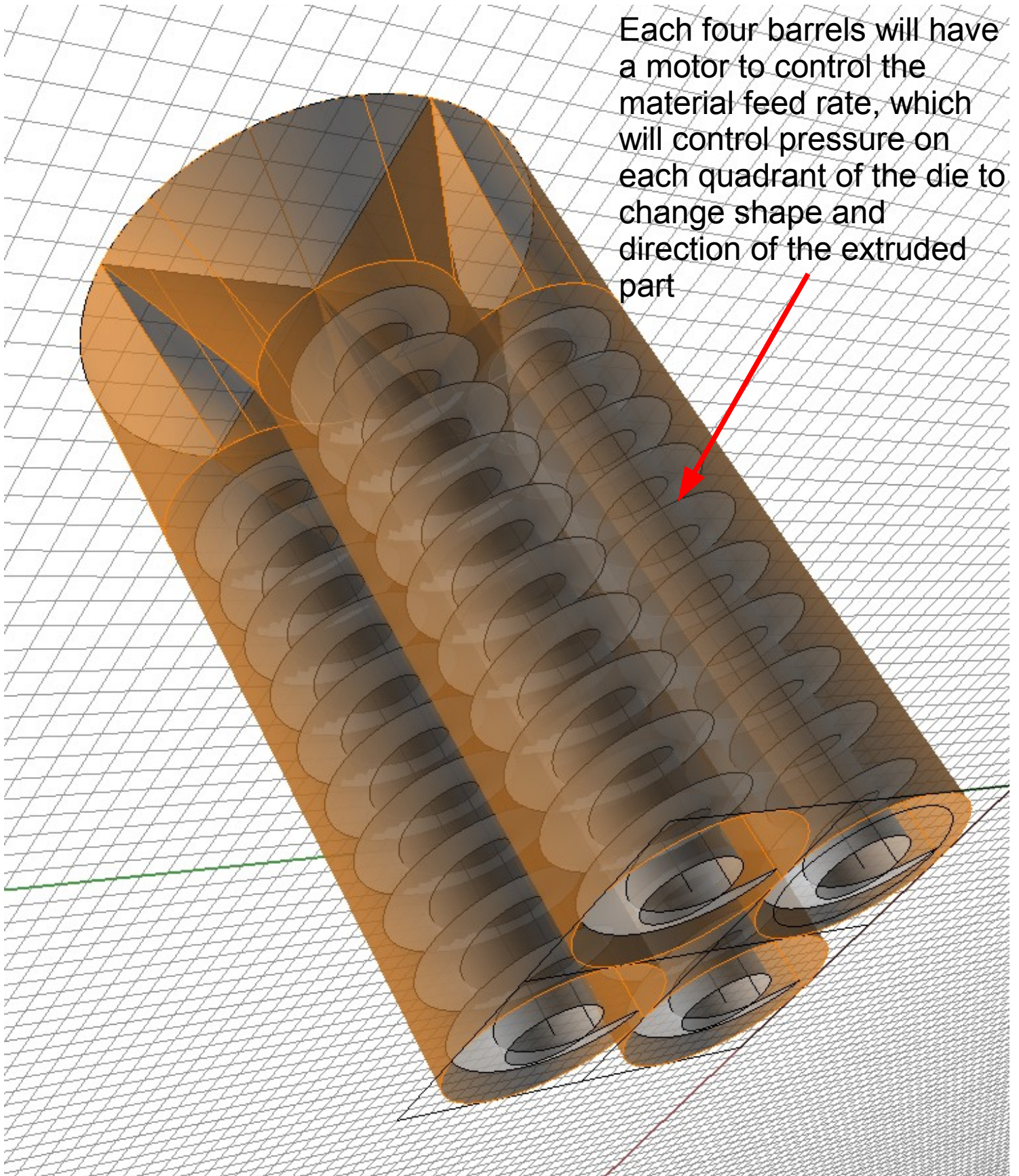

# DYNAMIC MATERIAL MIXING

to control hardness of cured extruded part

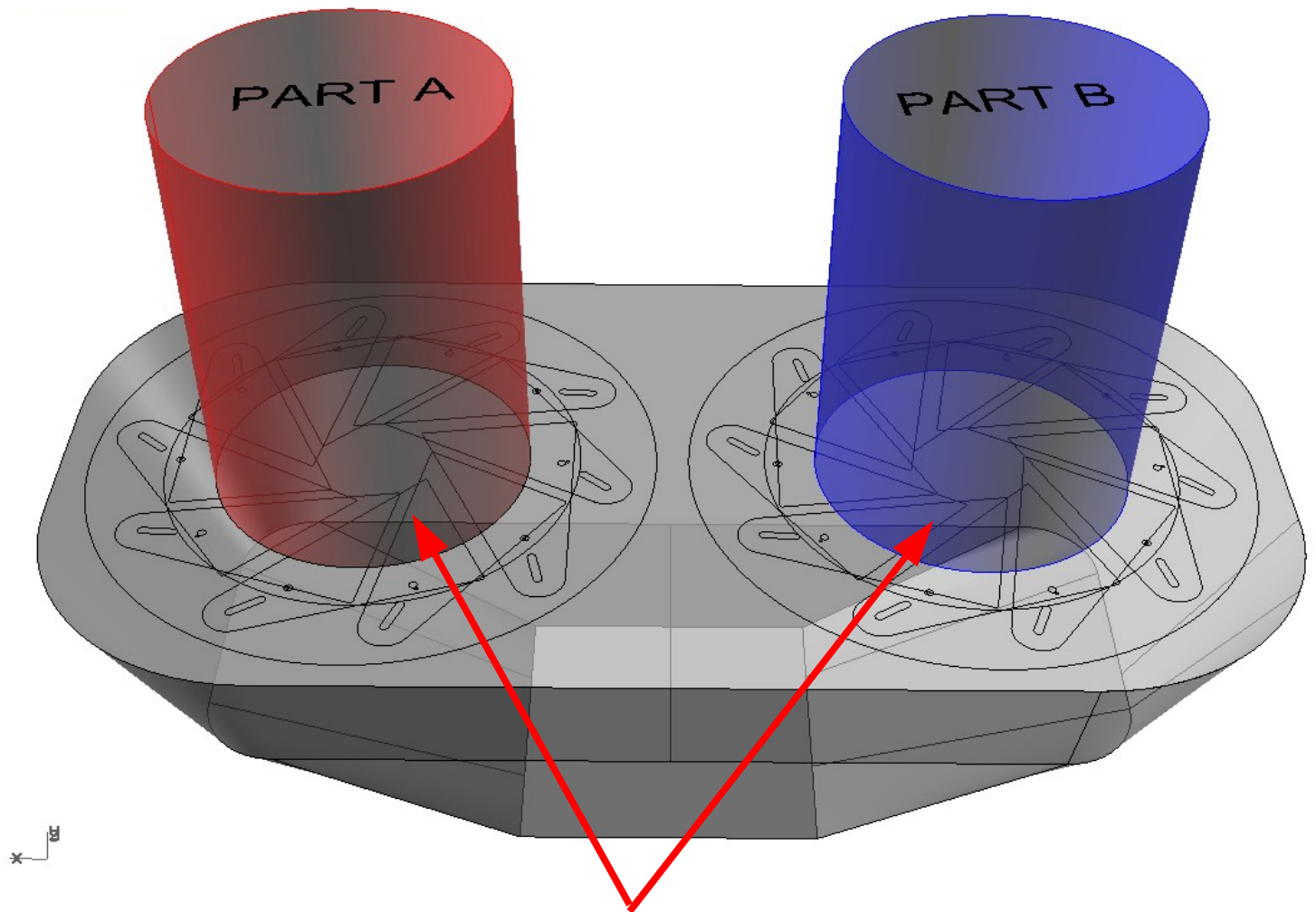

apertures connected  
to motors to control  
mixing ratio



**Material IN**

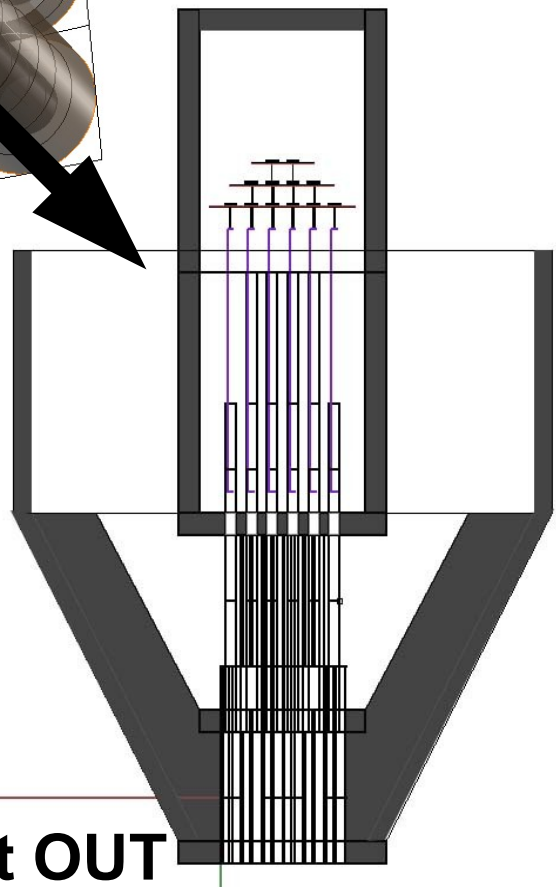
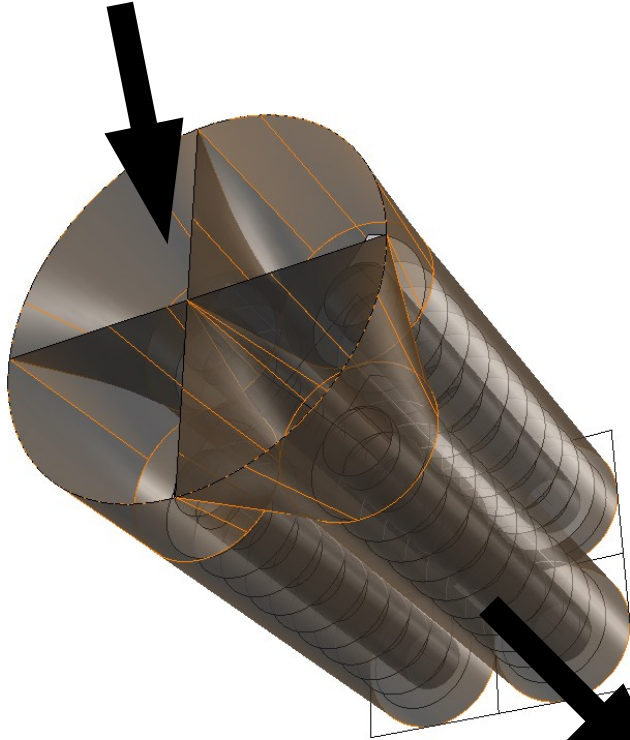
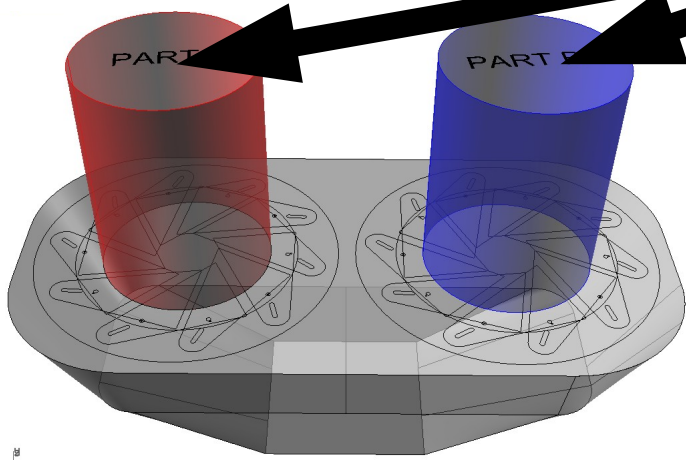

**Extruded Part OUT**